



What Your Florida-Friendly Landscape Can Be

Pam Brown
UF/IFAS Extension Agent Emeritus
pamperedgardeners.com

Objectives

- Florida-friendly landscaping principles
- Evaluating your site
- Creating a plan
- Choosing plants
- Admiring the results



Nine Principles of a Florida-Friendly Yard

- Right Plant, Right Place
- Water Efficiently
- Mulch (not cypress)
- Recycle
- Fertilize Appropriately
- Control Pests Responsibly
- Reduce Stormwater Runoff
- Provide Wildlife Habitat
- Protect The Waterfront



Evaluate Your Site

- Sun and shade patterns
- Wet or dry areas
- Power lines/utility boxes
- Inventory existing plants
 - Any invasives
 - Natives
 - Plants in the wrong place
 - What to keep?
- Water source



Create Your Plan

- Do research
 - <http://www.floridayards.org/>
 - <http://fyn.ifas.ufl.edu/FFL/index.html>
 - Visit nurseries
 - Observe landscape designs
- Measure your lot – create a plot plan
- Divide landscape into manageable projects
- Be flexible
- Be realistic
- Hire a professional, if needed

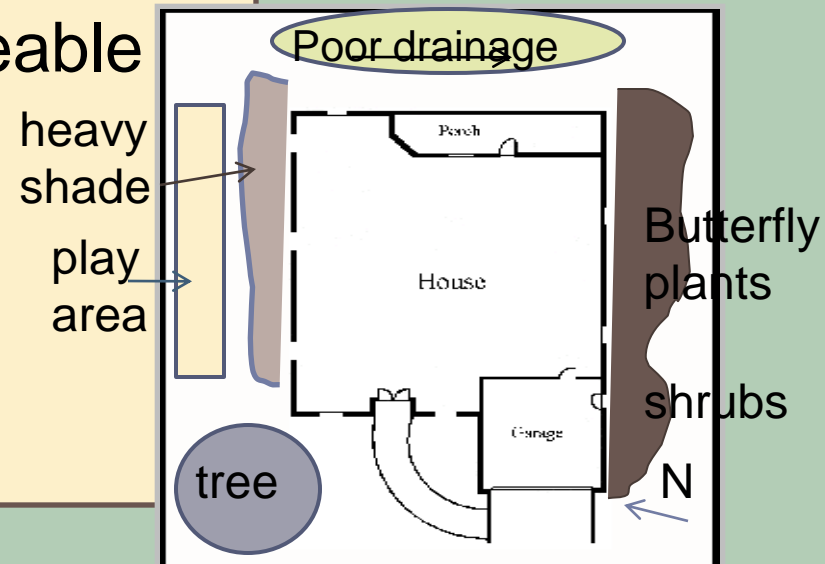
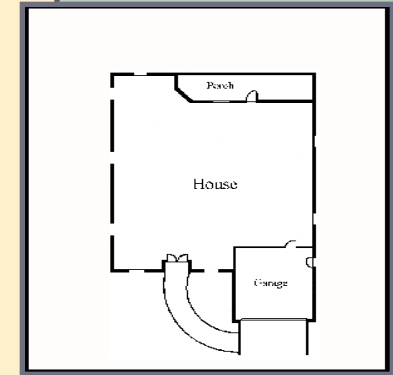

Plant Characteristics

- ▶ When selecting plants, choose the Right Plant for the Right Place
- ▶ Choose plants that reduce maintenance:
 - ▶ Drought tolerance
 - ▶ Correct for soil pH
 - ▶ Slower growing
 - ▶ Consider mature size
 - ▶ Characteristics you like



Plant Characteristics

- ▶ Other considerations :
 - ▶ Foliage, flower colors, bark, etc.
 - ▶ Growth habit
 - ▶ Trees
 - ▶ Shrubs
 - ▶ Vines
 - ▶ Ground covers
 - ▶ Annuals and Perennials
 - ▶ Wildlife Value
 - ▶ Salt tolerance
- ▶ For best results group colors & limit quantities



Develop a Plant List

- ▶ Educate yourself:
 - ▶ Refer to plant guides and UF IFAS fact sheets
www.watmatters.org
 - ▶ Visit FBG/Pinellas County
 - ▶ Visit other demonstrations
 - ▶ Library
 - ▶ Internet
 - ▶ <http://edis.ifas.ufl.edu>
 - ▶ Search engines
 - ▶ Garden center personnel

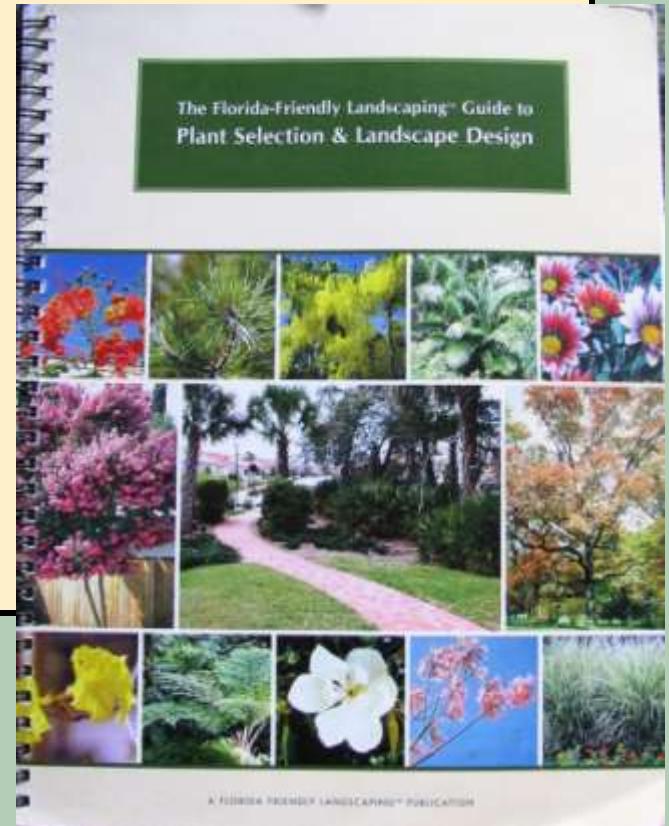

Develop a Plant List

Common Invasive Plants to avoid

- ▶ Asparagus fern – *Asparagus aethiopicus* (*A. sprengeri*)
- ▶ Orchid tree (*Bauhinia variegata*)
- ▶ Camphor tree (*Cinnamomum camphora*)
- ▶ Surinam cherry (*Eugenia uniflora*)
- ▶ Laurel fig (*Ficus microcarpa*, *F. nitida*)
- ▶ Lantana, shrub verbena (*Lantana camara*)
- ▶ Mexican petunia (*Ruellia simplex*)
- ▶ Schefflera, umbrella tree (*Schefflera actinophylla*)
- ▶ Arrowhead vine (*Syngonium podophyllum*)



Invasives to Avoid

**Mexican
Petunia**



Surinam Cherry



Schefflera



Lantana



Camphor tree



What Your Florida-Friendly Landscape Can Be



Before & After



All
Natives



Before & After

All Natives



Mostly native front yard







Intimate Back Yards



Small Spaces



No Grass



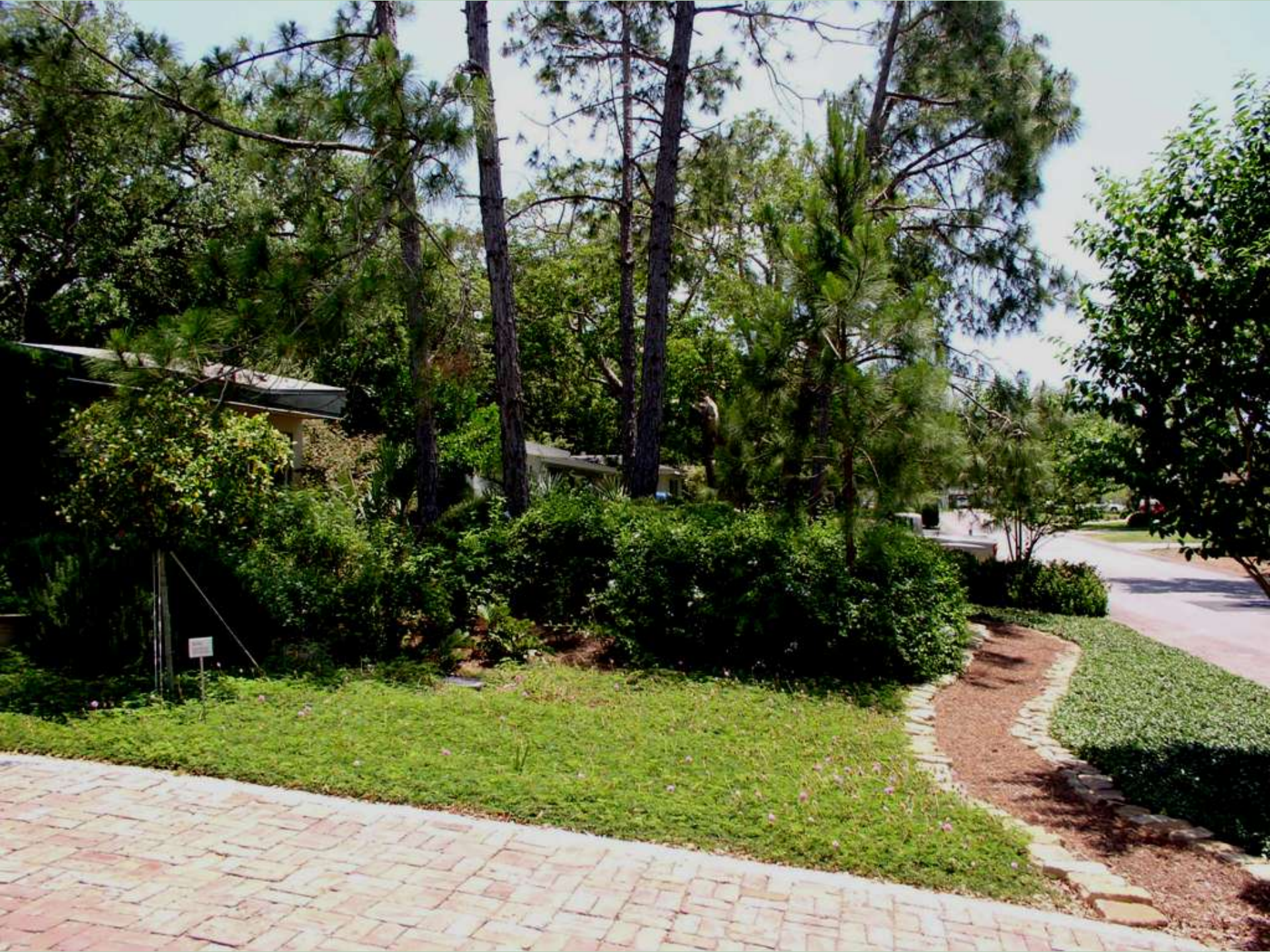





Native buffer at
water's edge





Florida-Friendly Condos Too!







Review

- ▶ Study and follow Florida-Friendly Principles
- ▶ Observe and evaluate your site
- ▶ Make a plan (divide into manageable sections)



A photograph of a white house with a large tree and a lawn. The house has a brown door and a large window with white shutters. The tree is in the foreground, and the lawn is green. The text "Questions??" is overlaid on the image.

Questions??